



MovinCool[®] Accessory Guide

The Portable Spot Cooling Solution





Custom Fit Your MovinCool to Cool Anything, Anyplace, Anywhere

Things to Consider When Choosing Your MovinCool Accessories

Warm Air Exhaust

All air-cooled units produce more hot air than cool air. If the cool air is ducted into an area, then warm air is not a problem. If the MovinCool is located within or close to the area being cooled, the warm air should be exhausted away from the area.

Condensate

Like most air conditioners, MovinCool not only cools the air, but also dehumidifies. The dehumidification process produces condensation, which collects in a tank at the base of the unit. The tank can be drained manually or by using the pump kit for automatic removal.

Make-up Air

When you attach the warm air duct, you are removing air from the room. Thus, air to the condenser will be replaced with air from surrounding areas. In most portable air conditioning applications, this situation is perfectly acceptable. And in some cases, this application may even improve or assist in cooling the area. However, an air plenum is recommended when the air outside the room is too hot or has too many impurities, or if the room is too airtight, which can negatively affect the performance of the unit.



How to Use this Guide

The most commonly used accessory installations are included in this guide.

1. Find your MovinCool model category: Office Pro, Classic/Classic Plus, or Classic 40/Classic 60.
2. Find the application(s) that is suited to your specific need.
3. Order the part number(s) for your specific MovinCool model.

Office Pro® 10 UNT00868

Auto Condensate Removal

Why bother with emptying the drain tank when you can install a condensate pump to remove the water automatically? This pump has an 18-foot lift capacity to reach virtually any remote drain.

Office Pro® 10

#	Part Name	Trane PN	MovinCool PN
1	Condensate Pump Kit ^(a)	PMP01638	CPK7
2	Adapter Plate	KIT09130	LAY45711-002A

Ceiling Tile

When windows are not available, connect condenser air exhaust system to the drop-ceiling space with the ceiling tile kit.

#	Part Name	Trane PN	MovinCool PN
3	Ceiling Tile Kit	PLT03778	LAY45771-0110

Remote Control

For additional convenience, the Office Pro® 10 remote allows complete control of the unit functions from anywhere in the room.

#	Part Name	Trane PN	MovinCool PN
4	Remote Control	CNT03770	LAY13090-0010

(a) #2 is required

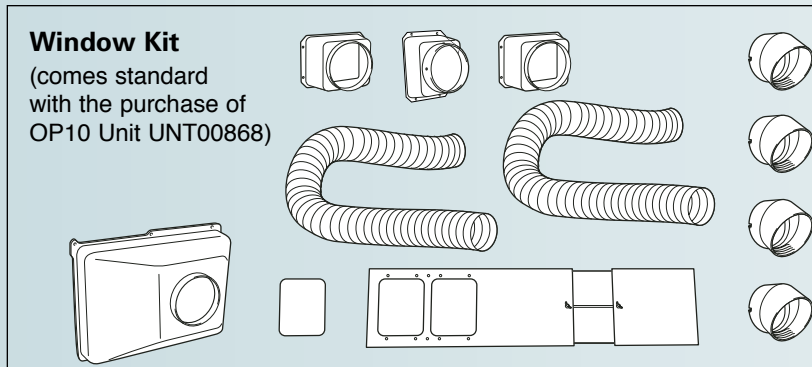

Individual Part Descriptions for MovinCool Office Pro® 10		
1	Condensate Pump Kit	110V pump kit includes 3/8" diameter x 20' length clear vinyl hose and installation hardware.
2	Adapter Plate	Plate which mounts to pump, must be purchased when using the Condensate Pump Kit.
3	Ceiling Tile Kit	24" x 24" white tile with 2 holes, 6" in diameter, with 2 warm air flexible ducts 12' in length.
4	Remote Control	Full function remote for quick and easy operation from distances up to 20 feet.

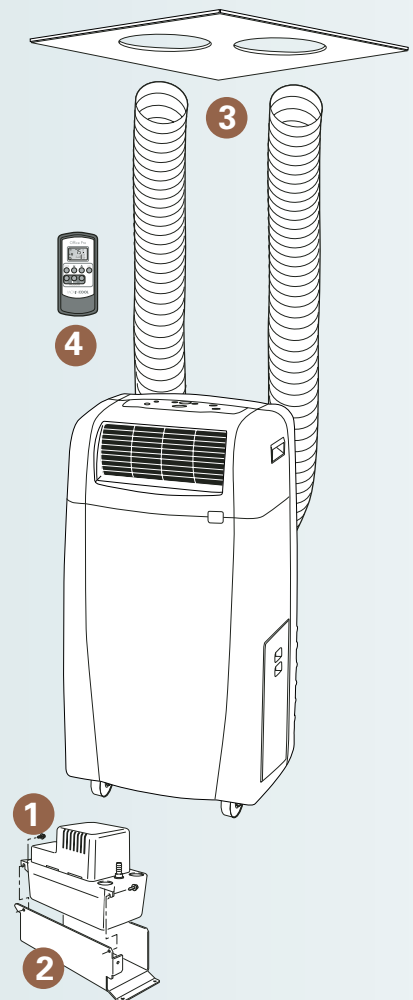



Office Pro® Series UNT00858, UNT00859, UNT00860, UNT00869

Auto Condensate Removal

Why bother with emptying the drain tank when you can install a condensate pump to remove the water automatically? This pump has an 18-foot lift capacity to reach virtually any remote drain.

#	Part Name	Office Pro® 12		Office Pro® 18		Office Pro® 24		Office Pro® 60	
		Trane PN	MovinCool PN	Trane PN	MovinCool PN	Trane PN	MovinCool PN	Trane PN	MovinCool PN
9	Condensate Pump Kit	PMP01588	CPK3	PMP01588	CPK3	PMP01590	CPK5	Included	Included
10	Condensate Tank	Included	Included	Included	Included	Included	Included	TNK00865	484730-0010
N/A	Condensate Float (not shown) ^(a)	N/A	N/A	N/A	N/A	N/A	N/A	N/A	484460-0010

Condenser Air Removal

MovinCool makes removing exhaust easy. Simply replace the existing ceiling tile with the MovinCool ceiling tile accessory. Place the self-supporting flexible duct on top of the unit and insert it into the ceiling tile. That's all it takes.

#	Part Name	Office Pro® 12		Office Pro® 18		Office Pro® 24		Office Pro® 60	
		Trane PN	MovinCool PN	Trane PN	MovinCool PN	Trane PN	MovinCool PN	Trane PN	MovinCool PN
6	Warm Air Self-Supported Duct	DUC01043	481744-0060	DUC01043	481744-0060	DUC01043	481744-0060	N/A	N/A
12	Warm Air Flexible Duct Kit	N/A	N/A	N/A	N/A	N/A	N/A	DUC01050	LAY45820-0010
7	Ceiling Tile ^(b)	PLT03642	LA146373-8280	PLT03642	LA146373-8280	PLT03642	LA146373-8280	N/A	N/A

Make-Up Air

When balanced airflow is required, attach the air plenum with a duct from the side of the unit to an outside air source. The air to the condenser is pulled from outside the room to eliminate problems associated with negative air pressure.

#	Part Name	Office Pro® 12		Office Pro® 18		Office Pro® 24		Office Pro® 60	
		Trane PN	MovinCool PN	Trane PN	MovinCool PN	Trane PN	MovinCool PN	Trane PN	MovinCool PN
6	Warm Air Self-Supported Duct	DUC01043	481744-0060	DUC01043	481744-0060	DUC01043	481744-0060	N/A	N/A
12	Warm Air Flexible Duct Kit	N/A	N/A	N/A	N/A	N/A	N/A	DUC01050	LAY45820-0010
7	Ceiling Tile ^(b)	PLT03642	LA146373-8280	PLT03642	LA146373-8280	PLT03642	LA146373-8280	N/A	N/A
8	Condenser Air Plenum	KIT07909	LAY84270-0010 ^(b)	KIT09415	LAY84270-008A ^(b)	KIT07913	LAY84270-0050 ^(b)	KIT07914	LAY84270-0060 ^(b)

Spot or Remote Cooling

To use the Office Pro to spot cool specific areas, use the nozzle adapter in place of the standard louvers. Attach cold air ducts to the adapter to cool remote hot spots. Trim rings give a finished look and keep the ducts from unraveling. To improve efficiency, use the evaporator air plenum to recirculate cool air.

#	Part Name	Office Pro® 12		Office Pro® 18		Office Pro® 24		Office Pro® 60	
		Trane PN	MovinCool PN	Trane PN	MovinCool PN	Trane PN	MovinCool PN	Trane PN	MovinCool PN
1	Nozzle Adapter Kit	ADP00978	LA481769-0170	ADP00978	LA481769-0170	NOZ00817	LAY84209-0010	ADP00979	LAY45770-0070(6")
1A	Duct Adapter Kit	N/A	N/A	N/A	N/A	N/A	N/A	ADP00980	LAY45770-0080(8")
2	Nozzle Kit * ^(c)	NOZ00829	LAY484209-0060	NOZ00829	LAY484209-0060	DUC01046	484209-0050	DUC01046	484209-0050 (6")
3	Cold Air Flange Kit * ^(c)	FLG01055	481170-0180	FLG01055	481170-0180	FLG01058	481170-0250	FLG01058	481170-0250 (6")
4	Cold Air Self-Supported Duct * ^(d)	DUC01044	481744-0090	DUC01044	481744-0090	DUC01041	481744-0030	DUC01041	481744-0030 (6")
4A	Cold Air Flexible Duct * ^(g)	N/A	N/A	N/A	N/A	N/A	N/A	DUC01104	LAY45810-0080 (8")
5	Trim Ring ^(e)	RNG01760	481851-0200	RNG01760	481851-0200	RNG01760	481851-0210	RNG01760	481851-0210 (6")
11	Evaporator Air Plenum ^(h)	N/A	N/A	N/A	N/A	N/A	N/A	KIT07915	LAY84270-0070

(a) #10 is required

(d) #1 & 3 are required

(g) #1A is required for Office Pro 60 only

NOTE: All part numbers come with one part except where noted. All kits include additional pieces such as clamps and screws. See parts description box for more information.

(b) #6 is required

(e) #4,3 & 1 are required

(h) #6 & 8 are required

(c) #1 is required

(f) #12 is required for Office Pro 60 only

* Order 1 or 2 parts depending on if 1 or 2 nozzles, flanges or ducts are needed.



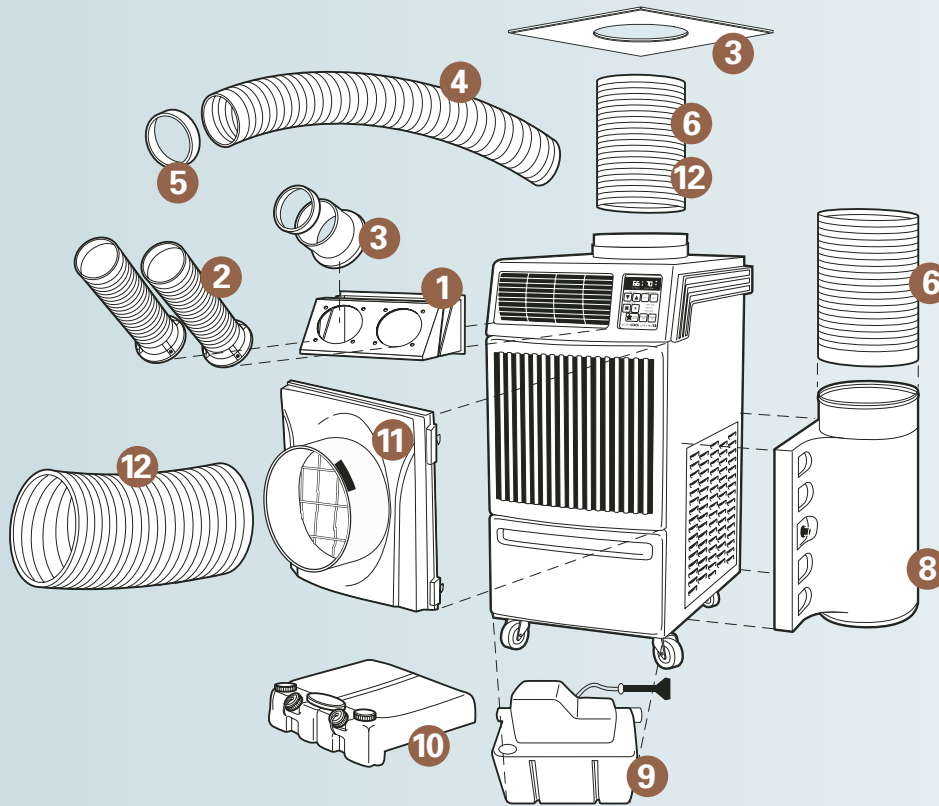

Individual Part Descriptions for MovinCool Office Pro® Series

1	Nozzle Adapter Kit	Two-piece metal frame converts airflow from louvers to nozzles or cold air ducts. Includes mounting screws. (Nozzles and ducts sold separately.)
1A	Duct Adapter Kit	Same as above, but for use with cold air flexible ducts. Includes flange. Use on Office Pro 60 only. (Cold air flexible ducts sold separately.)
2	Nozzle Kit	5" or 6" diameter white plastic nozzle that extends up to 3-½" in length. Includes flange, mounting screws and trim ring (Purchase in sets of two.)
3	Cold Air Flange Kit	5" or 6" diameter white metal flange with wire clamp and mounting screws. Use with cold air ducts.
4	Cold Air Self-Supported Duct	5", 6" or 8" adjustable diameter, white polypropylene duct that extends from 6-½' to 10' in length.
4A	Cold Air Flexible Duct	8" diameter wire-reinforced, accordion-style duct in 25' lengths. (For Office Pro 60 only)
5	Trim Ring	5" or 6" diameter black end-cap for cold air self-supported duct.
6	Warm Air Self-Supported Duct	12" diameter white, polypropylene plastic duct that extends 6-½' to 10' in length. (For Office Pro 12, 18 and 24 only)
12	Warm Air Flexible Duct Kit	16" diameter wire-reinforced, accordion-style duct in 25' lengths for condenser exhaust or evaporator intake. Includes clamp. (For Office Pro 60 only)
7	Ceiling Tile	24" x 24" white tile with 12" hole for warm air self-supported duct. (For Office Pro 12, 18 and 24 only)
8	Condenser Air Plenum	White plastic plenum for return air to condenser. Hinged for filter cleaning.
9	Condensate Pump Kit	110V or 220V pump kit includes 3/8" diameter x 20' length clear vinyl hose and installation hardware.
10	Condensate Tank	Drain tank storage for condensation. Requires condensate float, sold separately. (For Office Pro 60 only)
	Condensate Float (not shown)	Controls water level in condensate tanks. (For Office Pro 60 only)
11	Evaporator Air Plenum	White plastic plenum for return air to evaporator.(For Office Pro 60 only)
	Caster Swivel Locks (not shown)	Locks swivel on rear casters for improved maneuverability of Office Pro 60. Sold in sets of two. (Part Number LOK00032 /LAY46521-0020)



Classic Plus Series UNT00861, UNT00862, UNT00863, UNT00864

Auto Condensate Removal

Why bother with emptying the drain tank when you can install a condensate pump to remove the water automatically? This pump has an 18-ft. lift capacity to reach virtually any remote drain. With the condensate pump installed, drainage is automatic and access to the compartment is no longer necessary. A cover plate can then be added to conceal and protect the pump.

#	Part Name	Classic 10		Classic 18		Classic Plus 14		Classic Plus 26	
		Trane PN	MovinCool PN	Trane PN	MovinCool PN	Trane PN	MovinCool PN	Trane PN	MovinCool PN
9	Cover Plate	COV03325	484009-0480	COV03325	484009-0480	COV03325	484009-0480	COV03325	484009-0480
10	Condensate Pump Kit	PMP01587	CPK2	PMP01586	CPK1	PMP01588	CPK3	PMP01589	CPK4

Condenser Air Removal

To exhaust the warm condenser air above the work area, attach the warm air flange and duct to the top of the unit. When using MovinCool inside an office, simply replace the ceiling tile with the MovinCool ceiling tile and insert the duct to exhaust the warm air. No special tools or equipment are required for the installation.

#	Part Name	Classic 10		Classic 18		Classic Plus 14		Classic Plus 26	
		Trane PN	MovinCool PN	Trane PN	MovinCool PN	Trane PN	MovinCool PN	Trane PN	MovinCool PN
5	Warm Air Flange Kit	FLG01056	481170-0190	FLG01056	481170-0190	FLG01056	481170-0190	FLG01056	481170-0190
6	Warm Air Duct ^(a)	DUC01043	481744-0060	DUC01043	481744-0060	DUC01043	481744-0060	DUC01043	81744-0060
7	Ceiling Tile ^(b)	PLT03642	LA146373-8280	PLT03642	LA146373-8280	PLT03642	LA146373-8280	PLT03642	LA146373-8280

Make-Up Air

When balanced air flow is required, attach the air plenum with a duct from the side of the unit to an outside air source. The air to the condenser is pulled from outside the room to eliminate problems associated with negative air pressure.

#	Part Name	Classic 10		Classic 18		Classic Plus 14		Classic Plus 26	
		Trane PN	MovinCool PN	Trane PN	MovinCool PN	Trane PN	MovinCool PN	Trane PN	MovinCool PN
6	Air Duct ^(c)	DUC01043	481744-0060	DUC01043	481744-0060	DUC01043	481744-0060	DUC01043	481744-0060
7	Ceiling Tile ^(d)	PLT03642	LA146373-8280	PLT03642	LA146373-8280	PLT03642	LA146373-8280	PLT03642	LA146373-8280
8	Air Plenum	KIT07912	LAY84270-0040	KIT07910	LAY84270-0020	KIT07910	LAY84270-0020	KIT07911	LAY84270-0030

Remote Cooling

The amount of air supplied to remote areas can be quickly and conveniently increased by attaching 10-ft. extension ducts directly over the standard ducts. For more permanent installations, use the flange and clamp to secure the extension ducts to the unit. Each duct can be extended 30 to 60 feet from the unit, depending on the model. Add trim rings to the end of the extension ducts to give a finished look and keep the ducts from unraveling. The dual duct accessory can be used to divide each 5-inch nozzle opening into two 4-inch outlets to multiply your cooling options.

#	Part Name	Classic 10		Classic 18		Classic Plus 14		Classic Plus 26	
		Trane PN	MovinCool PN	Trane PN	MovinCool PN	Trane PN	MovinCool PN	Trane PN	MovinCool PN
1	Cold Air Flange Kit	FLG01055	481170-0180	FLG01055	481170-0180	FLG01055	481170-0180	FLG01053	481170-0250
2	Extension Duct ^(e)	DUC01044	481744-0090	DUC01044	481744-0090	DUC01044	481744-0090	DUC01041	481744-0030
3	Trim Ring ^(f)	RNG01760	481851-0200	RNG01760	481851-0200	RNG01760	481851-0200	RNG01761	481851-0210
4	Dual Duct	DUC01045	484209-0030	DUC01045	484209-0030	DUC01045	484209-0030	N/A	N/A

- (a) #5 is required
- (b) #5 & 6 are required
- (c) #8 is required
- (d) #6 & 8 are required
- (e) #1 is required
- (f) #2 & 1 are required

NOTE: All part numbers come with one part except where noted. All kits include additional pieces such as clamps and screws. See parts description box for more information.

MOVINCOOL
THE #1 PORTABLE SPOT COOLING SOLUTION



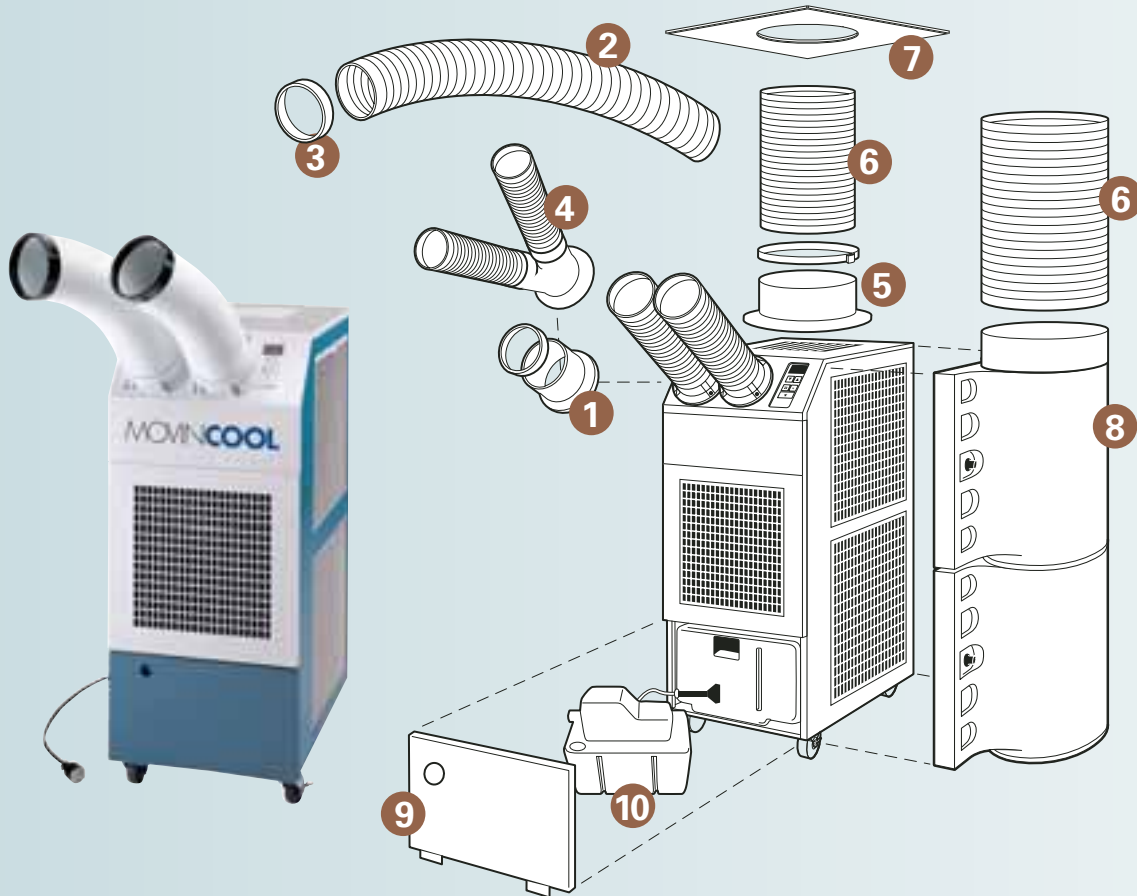

Individual Part Descriptions for MovinCool Classic/Classic Plus Series

1 Cold Air Flange Kit	5" or 6" diameter white metal flange with wire clamp and mounting screws.
2 Cold Air Extension Duct	5" or 6" diameter white plastic duct that extends from 6 ½' to 10' in length.
3 Trim Ring	5" or 6" diameter black plastic ring mounts as end caps for extension ducts.
4 Dual Duct	5" diameter white plastic flange with two 4' nozzles that extend to 3 ½' in length.
5 Warm Air Flange Kit	12" diameter gray metal flange with wire clamp and mounting screws.
6 Warm Air Duct	12" adjustable diameter white plastic duct that extends from 6 ½' to 10' in length.
7 Ceiling Tile	24" x 24" white tile with 12" hole for warm air duct.
8 Air Plenum	White plastic plenum, hinged for filter cleaning.
9 Cover Plate	Blue metal plate covers condensate collection area.
10 Condensate Pump Kit	110V or 220V pump kit includes 3/8" diameter x 20' length hose and installation hardware.



Classic Series UNT00865, UNT00866

Multiple or Remote Area Cooling

Cooling several hot spots is not a problem with the two- or three-way chamber. Extension ducts in 10-ft. sections can be used to bring cooling to remote or different locations. Attach trim rings at the end of the extension ducts to give a finished look and keep the ducts from unraveling.

#	Part Name	Classic 40		Classic 60	
		Trane PN	MovinCool PN	Trane PN	MovinCool PN
1	Cold Air Flange Kit	FLG01056	481170-0190	FLG01056	481170-0190
2	Chamber Extender	CHB00160	481849-1431 ^(a)	CHB00160	481849-1431 ^(b)
2A	Chamber Extender Flange Kit*	FLG01053	481170-0090	FLG01053	481170-0090 ^(a)
3	Two-way Chamber	CHB01058	481769-0041	CHB01058	481769-0041 ^(a)
3A	Three-way Chamber (not shown)	CHB00159	481769-0051	CHB00159	481769-0051 ^(a)
3B	Reducer Flange Kit	N/A	N/A	FLG01054	481170-0150
4	Extension Duct (6-inch) ^(c)	DUC01041	481744-0030	DUC01041	481744-0030
5	Trim Ring ^(c)	RNG01761	481851-0210	RNG01761	481851-0210
6	Extension Duct (12-inch) ^(d)	DUC01043	481744-0060	DUC01043	481744-0060

Remote Control

When the unit is installed in a remote location, such as outdoors or overhead, use the remote control to allow convenient access to controls. The kit includes the operational control, a cover plate to prevent tampering with controls, and installation hardware. Use six 18AWG plus one ground wire to connect the control to the unit (wire not included).

#	Part Name	Classic 40		Classic 60	
		Trane PN	MovinCool PN	Trane PN	MovinCool PN
10	Remote Control Kit	CNT03694	484500-0430	CNT03694	484500-0430

Portability

To allow portability of these high-capacity MovinCool units, use the roller kit or the wagon kit. The stand kit provides proper ground clearance for permanent exterior installations.

#	Part Name	Classic 40		Classic 60	
		Trane PN	MovinCool PN	Trane PN	MovinCool PN
7	Stand Kit	KIT07918	484750-0020	N/A	N/A
8	Wagon Kit	KIT07917	484710-0020	N/A	N/A
9	Caster Kit	KIT07916	484709-0011	KIT07916	484709-0020

- (a) #3B is required for Classic 60 only
- (b) #3 is required (order 2 or 3 ducts depending on chamber selected)
- (c) #3 & 4 are required
- (d) #1 is required
- (e) #2A is required
- (f) #2A & 3B are required for Classic 60 only
- * Must order quantity of 2 per each Chamber Extender used

NOTE: All part numbers come with one part except where noted. All kits include additional pieces such as clamps and screws. See parts description box for more information.



MOVINCOOL
THE #1 PORTABLE SPOT COOLING SOLUTION



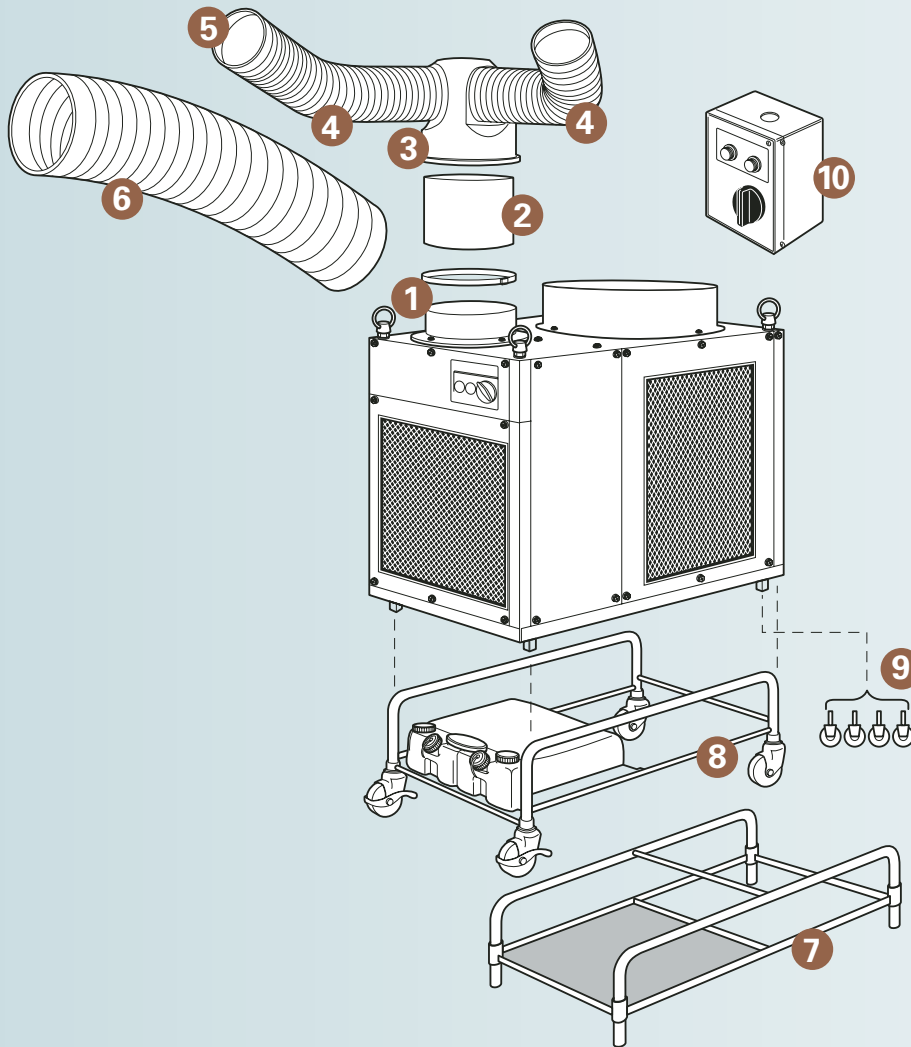

Individual Part Descriptions for MovinCool Classic 40/Classic 60

1 Cold Air Flange Kit	12" diameter gray metal flange with wire clamp and mounting screws.
2 Chamber Extender	Gray metal cylinder raises exhaust air chamber 16" above unit.
2A Chamber Extender Flange Kit	Gray metal flange connects chamber extender to unit. (not shown)
3 Two-way Chamber	Insulated gray plastic chamber diverts airflow in two directions. Use 6" extension ducts.
3A Three-way Chamber (not shown)	Diverts airflow in three directions. Use 6" extension ducts.
3B Reducer Flange Kit (not shown)	Gray metal flange converts mounting holes on Classic 60 for two- or three-way chamber and chamber extender flange.
4 Extension Duct	6" adjustable diameter white plastic duct that extends from 6 ½' to 10' in length.
5 Trim Ring	6" diameter black plastic end cap for extension duct.
6 Extension Duct	12" adjustable diameter white plastic duct that extends from 6 ½' to 10' in length.
7 Stand Kit	Blue metal, tubular frame raises unit off the ground. Available for Classic 40 only)
8 Wagon Kit	Blue metal, tubular frame with four casters, drain spout assembly and two 5-gal. condensate tanks. (Available for Classic 40 only)
9 Caster Kit	Four casters and wrench.
10 Remote Control Kit	Kit includes remote control box and installation hardware. Use six 18AWG plus one ground wire (wire not included).



MOVINCOOL
THE #1 PORTABLE SPOT COOLING SOLUTION



UNT00868
Office Pro® 10

UNT00858
Office Pro® 12

		UNT00868 Office Pro® 10	UNT00858 Office Pro® 12
Electronic Features	Control Panel	Programmable	Programmable
	Thermostat Control	Electronic	Electronic
Cooling Capacity	Rating conditions:	9,600 Btu/h	11,800 Btu/h
	95°F AT 60% RH		
Electrical Characteristics	Voltage Requirement	1 Phase, 115V	1 Phase, 115V
	Total Power Consumption	1.25 kW	1.4 kW
	Current Consumption	11.5 amps	11.2 amps
	Recommended Fuse Size	15 amps	15 amps
	NEMA Plug Configuration	5-15	5-15
	Min. - Max. Voltage	105-125	105-125
Fans	Motor Output - high/low	0.08/0.05 kW Evap. 0.19 kW Cond.	0.14/0.08 kW
Evaporator	Fan Type	Impeller	Centrifugal
	Max. Air Flow - high/low	205/175 CFM	410/380 CFM
	Max. External Static Pressure	0.27 IWG	0.31 IWG
Condenser	Fan Type	Impeller	Centrifugal
	Max. Air Flow - high/low	370 CFM	820/715 CFM
	Max. External Static Pressure	0.52 IWG	0.16 IWG
Compressor	Type	Hermetic Rotary	Hermetic Rotary
	Output	0.68 kW	0.8 kW
R-22 Charge		1.61 lb	0.95 lb
Dimensions	W x D x H	22 x 14 x 38 in	21 x 27 x 44 in
Net Weight/Shipping Weight		130/172 lb	165/195 lb
Power Cord	Gauge	14 AWG (3-core)	14 AWG (3-core)
	Length	6 ft	10 ft
Condensate Tank Capacity		2.4 gal	5 gal
Operating Conditions	Min. - Max. (@ 50% RH)	65° - 95°F	65° - 95°F
Max. Duct Length	Per Cold Duct Hose	N/A	30 ft
	Hot Duct Hose	25 ft	60 ft
Max. Sound Level	With Condenser Duct - high/low	58/56 dB	52/50 dB
	Without Condenser Duct - high/low	60/58 dB	55/53 dB

All specifications subject to change without notice. Standard warranty includes 12 months on entire unit and 36 months on the compressor. All models feature compressor overload relay and fan motor protection. All models also feature compressor short-cycle protection, return air thermostat, automatic restart and accommodate a condensate pump kit. All models are 50 Hertz (Hz) compatible with a slight performance decrease from specifications listed above.



UNT00869
Office Pro® 18

UNT00859
Office Pro® 24

UNT00860
Office Pro® 60

UNT00863
Classic 10

UNT00861
Classic Plus 14

Programmable
Electronic
16,800 Btu/h

1 Phase, 115V
1.7 kW
15.6 amps
20 amps
5-20
105-125
0.24/0.19 kW

Centrifugal
540/500 CFM
0.31 IWG

Centrifugal
770/710 CFM
0.23 IWG

Hermetic Rotary
0.95 kW
1.54 lb
21 x 27 x 44 in
177/207 lb
12 AWG (3-core)
10 ft
5 gal
65° – 95°F
25 ft
100 ft
61/59 dB
62/60 dB

Programmable
Electronic
23,300 Btu/h

1 Phase, 208/230V
2.7 kW
11.2 amps
20 amps
L6-20
195-250
0.48/0.41 kW

Centrifugal
630/545 CFM
0.5 IWG

Centrifugal
870/760 CFM
0.16 IWG

Hermetic Rotary
1.4 kW
2.14 lb
21 x 27 x 47 in
210/250 lb
12 AWG (3-core)
6 ft
5 gal
65° – 95°F
50 ft
45 ft
63/61 dB
65/63 dB

Programmable
Electronic
59,500 Btu/h

1Phase, 208/230V
7.1 kW
33 amps
50 amps
6-50
195-250
0.6/0.33 kW Evap.
1.2/0.92 kW Cond.

Centrifugal
1940/1770 CFM
0.9 IWG

Centrifugal
2830/2650 CFM
0.85 IWG

Hermetic Scroll
4.7 kW
6.83 lb
30 x 52 x 64 in
625/755 lb
6 AWG (3-core)
6 ft
Auto Pump Included
65° – 105°F
40 ft
100 ft
69/67 dB
71/69 dB

Mechanical
Mechanical
10,000 Btu/h

1 Phase, 115V
1.1 kW
10.6 amps
15 amps
5-15
105-125
0.14 kW
0.40 kW Cond.

Centrifugal
270 CFM
0.33 IWG

Centrifugal
740 CFM
0.13 IWG

Hermetic Rotary
0.6 kW
1.15 lb
19 x 26 x 41 in
145/170 lb
14 AWG (3-core)
6 ft
5 gal
68° – 105°F
40 ft
60 ft
55 dB
58 dB

Electronic
Electronic
13,200 Btu/h

1 Phase, 115V
1.3 kW
12.3 amps
15 amps
5-15
105-125
0.24/0.19 kW

Centrifugal
440/380 CFM
0.31 IWG

Centrifugal
880/760 CFM
0.19 IWG

Hermetic Rotary
0.8 kW
1.5 lb
19 x 26 x 41 in
153/195 lb
14 AWG (3-core)
10 ft
5 gal
70° – 113°F
30 ft
60 ft
57/55 dB
60/58 dB



UNT00864
Classic 18

UNT0862
Classic Plus 26

UNT00865
Classic 40

UNT00866
Classic 60

Mechanical	Electronic	Mechanical	Mechanical
Mechanical	Electronic	Mechanical	Mechanical
18,000 Btu/h	24,000 Btu/h	39,000 Btu/h	60,000 Btu/h
1 Phase, 208/230V	1 Phase, 208/230V	3 Phase, 220V	3 Phase, 460V
2.1 kW	3.1 kW	4.7 kW	7.2 kW
10.8/10.0 amps	15.6/14.0 amps	14 amps	10.5 amps
15 amps	20 amps	25 amps	20 amps
6-15	L6-20	L15-30	N/A
190-250	190-250	190-250	440 – 480
0.35 kW	0.55/0.38 kW	0.75 kW Evap. 0.40 kW Cond.	0.75 kW Evap. 0.40 kW Cond.
Centrifugal	Centrifugal	Centrifugal	Centrifugal
530 CFM	708/600 CFM	1060 CFM	1580 CFM
0.52 IWG	0.54 IWG	1.72 IWG	1.35 IWG
Centrifugal	Centrifugal	Propeller	Propeller
1180 CFM	1680/1460 CFM	2650 CFM	3800 CFM
0.25 IWG	0.25 IWG	0.05 IWG	0.05 IWG
Hermetic Rotary	Hermetic Scroll	Hermetic Reciprocal	Hermetic Reciprocal
1.1 kW	1.6 kW	2.2 kW	3.75 kW
1.59 lb	1.87 lb	4.4 lb	5.9 lb
19 x 26 x 41 in	19 x 29 x 47 in	26 x 43 x 39 in	32 x 49 x 42 in
167/200 lb	235/265 lb	353/420 lb	463/545 lb
14 AWG (3-core)	12 AWG (3-core)	12 AWG (4-core)	12 AWG (4-core)
6 ft	6 ft	6 ft	N/A
5 gal	5 gal	2@ 5 gal (optional)	N/A
68° – 105°F	70° – 113°F	75° – 115°F	75° – 115°F
50 ft	60 ft	Varies	Varies
60 ft	45 ft	40 ft	40 ft
63 dB	66/64 dB	N/A	N/A
67 dB	69/67 dB	72 dB	72 dB



DENSO SALES CALIFORNIA, INC.
REGISTERED TO ISO 9002
FILE NO. A5537



Portable Spot Cooling Solutions with MovinCool Accessories

The portability and all-in-one design of MovinCool air conditioners make them the ideal cooling solution for virtually any heat-related problem. Using the optional accessories not only gives you the ability to customize the cooling application, but also makes the unit work more efficiently. In this guide, we've grouped the accessories into the most commonly used applications such as cooling multiple areas with one unit, automatically removing condensate, and adding a remote control. The possibilities are endless. And, with genuine MovinCool accessories, you are assured of quality parts engineered and designed specifically to gain optimum performance from your MovinCool portable air conditioner.



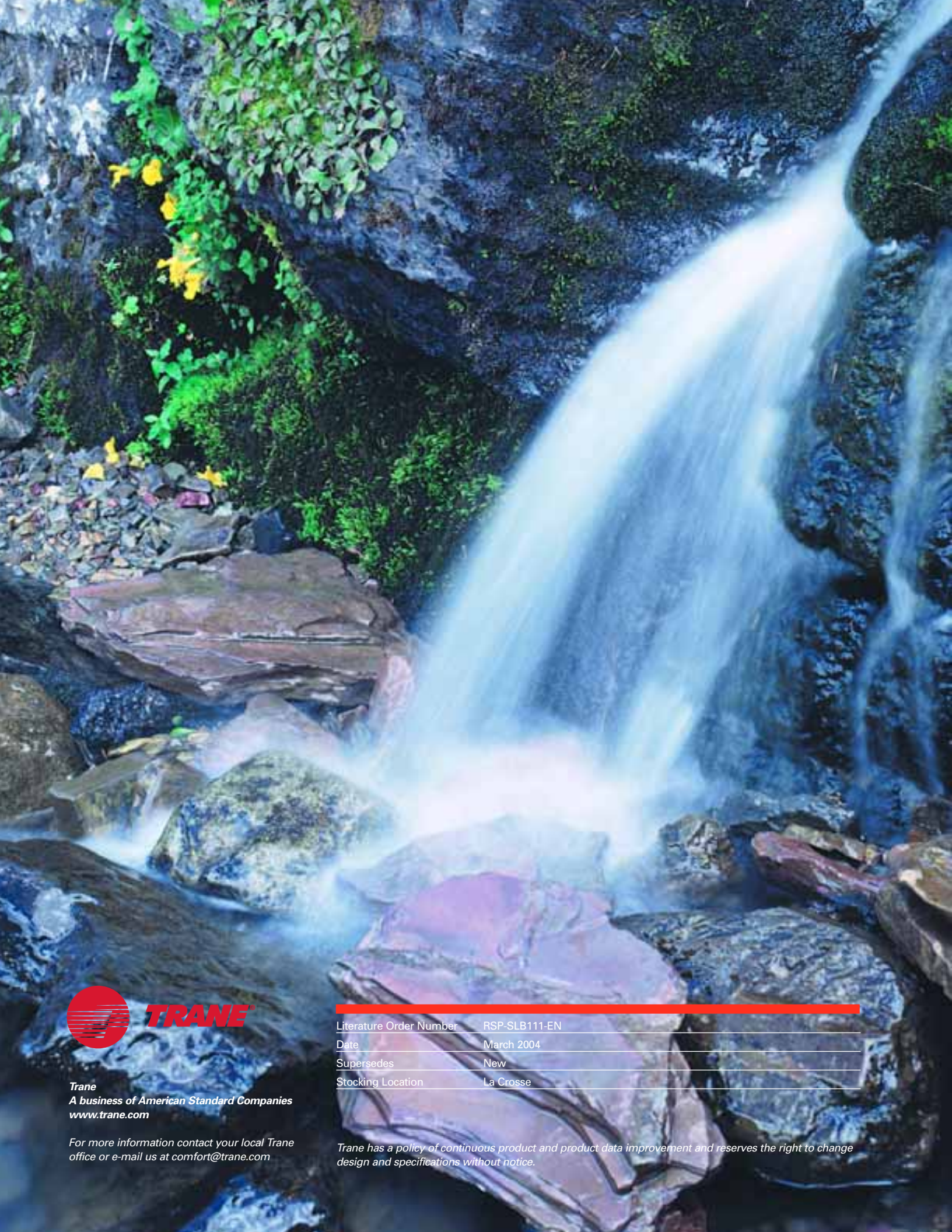

Trane
A business of American Standard Companies
www.trane.com

For more information contact your local Trane office or e-mail us at comfort@trane.com

Literature Order Number	RSP-SLB111-EN
Date	March 2004
Supersedes	New
Stocking Location	La Crosse

Trane has a policy of continuous product and product data improvement and reserves the right to change design and specifications without notice.