

User Guide

Variable Refrigerant Flow (VRF) System Wireless Remote Control

Model Number: TVCTRLRDH00T
TVCTRLRDH00UA

SAFETY WARNING

Only qualified personnel should install and service the equipment. The installation, starting up, and servicing of heating, ventilating, and air-conditioning equipment can be hazardous and requires specific knowledge and training. Improperly installed, adjusted or altered equipment by an unqualified person could result in death or serious injury. When working on the equipment, observe all precautions in the literature and on the tags, stickers, and labels that are attached to the equipment.

WARNING Indicates a potentially hazardous situation which, if not avoided, could result in death or serious injury.

CAUTION Indicates a potentially hazardous situation which, if not avoided, could result in minor or moderate injury. It could also be used to alert against unsafe practices.

NOTICE: Indicates a situation that could result in equipment or property-damage only accidents.

August 2013

© 2013 Trane
All rights reserved

VRF-SVU40A-EN

Wireless Remote Control

Figure 3. Buttons and their functions

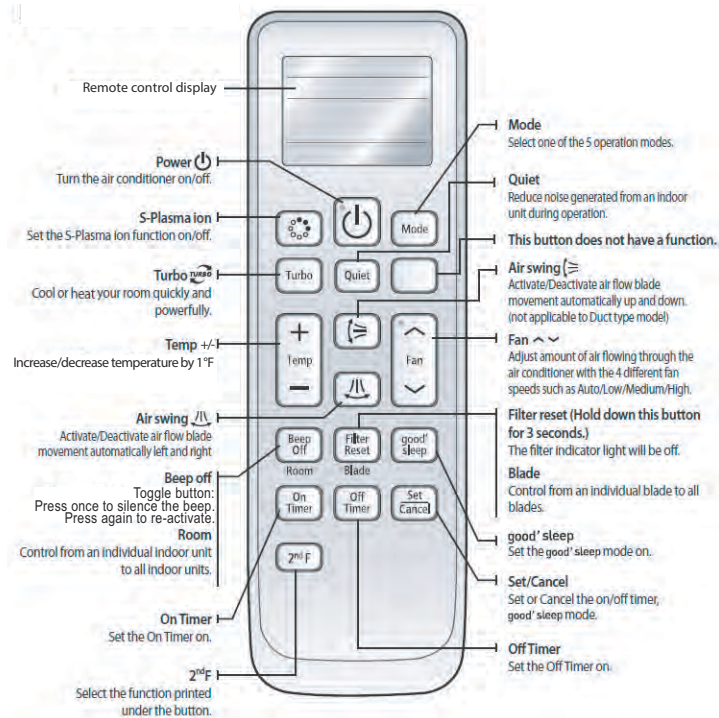

1

Important: Environmental Concerns! Scientific research has shown that certain man-made chemicals can affect the earth's naturally occurring stratospheric ozone layer when released to the atmosphere. In particular, several of the identified chemicals that may affect the ozone layer are refrigerants that contain Chlorine, Fluorine and Carbon (CFCs) and those containing Hydrogen, Chlorine, Fluorine and Carbon (HCFCs). Not all refrigerants containing these compounds have the same potential impact to the environment. Trane advocates the responsible handling of all refrigerants-including industry replacements for CFCs such as HCFCs and HFCs.

Important: Responsible Refrigerant Practices! Trane believes that responsible refrigerant practices are important to the environment, our customers, and the air conditioning industry. All technicians who handle refrigerants must be certified. The Federal Clean Air Act (Section 608) sets forth the requirements for handling, reclaiming, recovering and recycling of certain refrigerants and the equipment that is used in these service procedures. In addition, some states or municipalities may have additional requirements that must also be adhered to for responsible management of refrigerants. Know the applicable laws and follow them.

WARNING

Personal Protective Equipment Required!

Installing/servicing this unit could result in exposure to electrical, mechanical and chemical hazards. Before installing/servicing this unit, technicians MUST put on all Personal Protective Equipment (PPE) recommended for the work being undertaken. ALWAYS refer to appropriate MSDS sheets and OSHA guidelines for proper PPE. When working with or around hazardous chemicals, ALWAYS refer to the appropriate MSDS sheets and OSHA guidelines for information on allowable personal exposure levels, proper respiratory protection and handling recommendations. If there is a risk of arc or flash, technicians MUST put on all necessary Personal Protective Equipment (PPE) in accordance with NFPA70E for arc/flash protection PRIOR to servicing the unit. Failure to follow recommendations could result in death or serious injury.

WARNING

Proper Field Wiring and Grounding Required!

All field wiring MUST be performed by qualified personnel. Improperly installed and grounded field wiring poses FIRE and ELECTROCUTION hazards. To avoid these hazards, you MUST follow requirements for field wiring installation and grounding as described in NEC and your local/state electrical codes. Failure to follow code could result in death or serious injury.

2

Components

Ensure that the following accessories are present:

Figure 1. Wireless remote control accessories

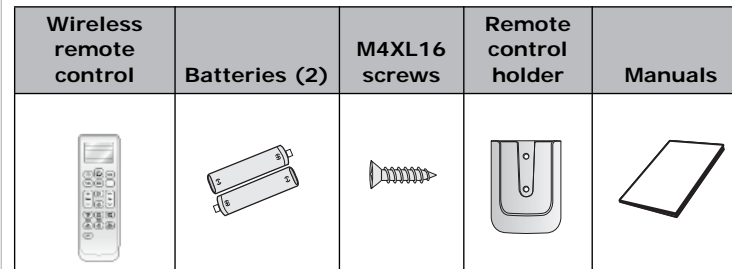

Find a suitable location for the holder and attach it to the wall.

3

Remote Control Holder

Location

Install the remote control holder in a location that meets the following requirements:

- No interference to the remote control signal
- No exposure to direct sunlight or heat source
- More than 3.28 ft (1m) away from a television or stereo system

Installation

Mount the holder as follows:

1. Mark the spots where you will install remote control holder by a pencil.
2. Drill the marked holes (2 each) for screws on the wall.
3. Install the remote control holder on the wall by using the screws.

Figure 2. Mounting the control holder

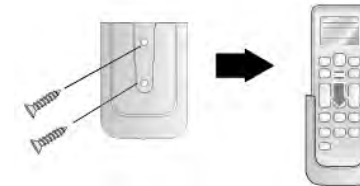

5

Notes:

- 2ndF button changes the function of the **Beep Off** button to **Room** and **Filter Reset** button to **Blade**. To restore the button function to **Beep Off** and **Filter Reset**, press the 2ndF button again.
- Functions not supported by your unit model will not operate, even if they appear on the remote control display.

Figure 4. Display Indicators

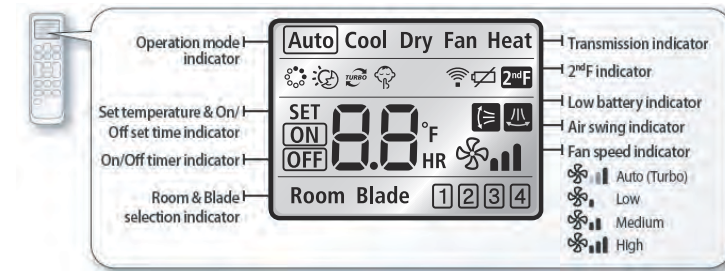

Operation

To activate a control function, point the remote control towards the remote control receiver of the indoor unit. When you press a button on the remote control, you will hear a beep sound from the indoor unit. A transmit indicator (shown at left) appears on the remote control display.

Notes:

- There is a possibility that the indoor unit will not operate by remote control near strong light such as a fluorescent lamp or a neon sign. If this occurs, point the remote control at the remote control receiver of the indoor unit.
- If the remote control is causing other electrical products to be operated, call your nearest service center.

6

Operating Modes

Press the **Mode** button to select one of the following operating modes:

Note: The system may not respond to the remote control signal if the building is currently operating in a mode that is in conflict with the mode you are requesting (for example, a request for cooling when the building is currently heating, or vice versa).

Auto

In Auto mode, the indoor unit automatically sets the temperature and fan speed to maintain the selected temperature. If the indoor temperature is too high, a cooling breeze is generated until the room returns to a comfortable level. As the room cools, the fan slows down and maintains a gentle airflow.

Cool

Cool mode is frequently used and you can freely control the temperature, fan speed, and air flow direction in cool mode.

When you select heat mode while the unit is in cool mode, the cool mode request is canceled.

Dry

The unit in Dry mode acts like a dehumidifier by removing moisture from the indoor air.

Fan

In Fan mode, you can ventilate your room. Fan operation helps to maintain a satisfactory indoor environment.

Heat

While the unit is in heat mode, be aware of the following:

- There may be a delay before the fan begins running to avoid generating a cold breeze.
- The defrost indicator (shown at left) will appear when frost is being removed from the outdoor unit. When the defrost function is completed, the defrost indicator disappears.
- If you stop heating operation, the fan will continue running for a period of time to cool the unit.
- If you select cool mode while the unit is in heat mode, the heat mode request is canceled.

7

Basic operation tasks

Perform the following basic operation tasks:

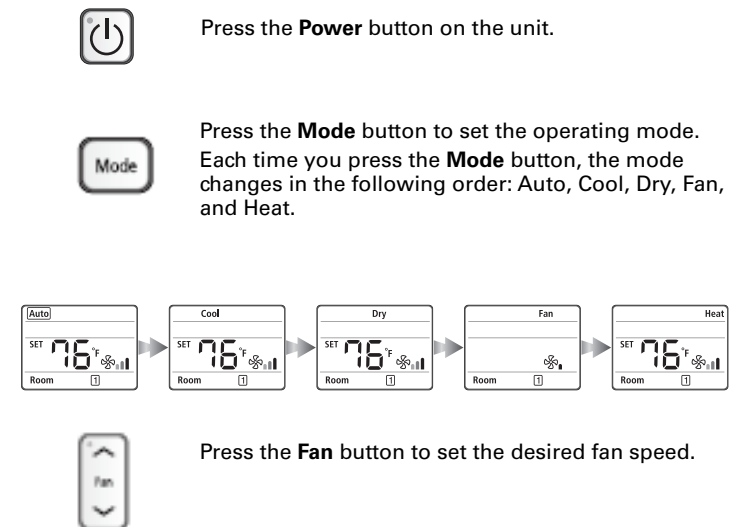

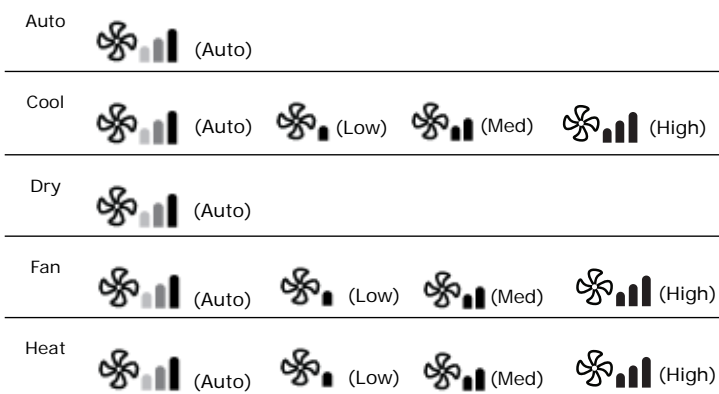

Press the Temp button to adjust the desired temperature.

Auto	You can adjust the desired temperature by 1°F within the range of 65°F–86°F.
Cool	Cool You can adjust the desired temperature by 1°F within the range of 65°F–86°F.
Dry	Dry You can adjust the desired temperature by 1°F within the range of 65°F–86°F.
Fan	Fan Temperature adjustment is not possible.
Heat	Heat You can adjust the desired temperature by 1°F within the range of 61°F–86°F.

Turbo Operation

Use Turbo operation to heat or cool a room quickly. Press the Turbo button (shown at left) on the remote control while in Cool/Heat mode.

The Turbo indicator (shown at left) appears on the remote controller display and the unit operates in Turbo function for 30 minutes. If you press the Turbo button again, the Turbo operation is canceled.

Be aware of these additional facts:

- Turbo function is only available in the Cool/Heat mode.
- If you select the Turbo operation during the Quiet operation, the Quiet operation is canceled.
- You can adjust the air flow direction Up/Down or Left/Right.
- You cannot adjust the set temperature and fan speed.

Figure 5. Buttons used to start the Turbo function

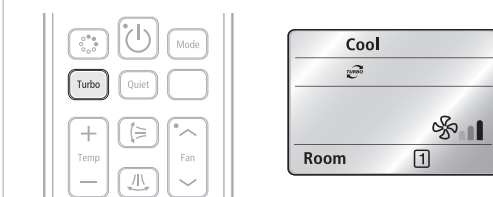

Quiet Operation

Use this function to reduce the noise generated during air condition operation.

Press the **Quiet** button to select Quiet Operation. If you press the Quiet button once again, the Quiet operation is canceled.



In Cool mode:

You can adjust the desired temperature by 1°F within the range of 65°F–86°F.

In Heat mode:

You can adjust the desired temperature by 1°F within the range of 61°F–86°F.



Since the fan speed is fixed as Auto, the fan speed is not controlled by Fan speed button.



You can set the air flow direction Up/Down or Left/Right.



Note: You can select the Quiet operation while the unit is in cool or heat mode. If you select the Quiet operation during the Turbo operation, the Turbo operation is canceled.

Figure 6. Button used to start Quiet operation

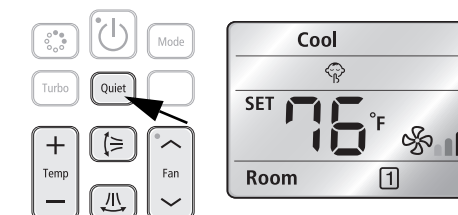

Air Swing Operation

Note: Air Swing operation is available only with high-wall and convertible ceiling/floor indoor units.

This function allows you to shift the air flow direction up and down or left and right.

1. Press the vertical or horizontal swing button (shown at left) to move the air flow direction up and down or left and right while the unit is on.
2. When the blade reaches the desired position, press the vertical or horizontal swing button one more time to set the air flow direction. The up/down and left/right tilting of the blade will stop.

Figure 7. Buttons used to start Air Swing operation

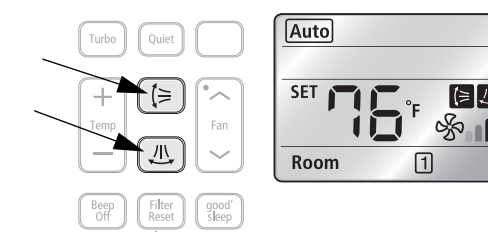

Sleep Mode

Note: Sleep mode is available only with high-wall indoor units.

In this mode, the unit will operate in Fall asleep > Sound sleep > Wake up from Sleep mode.

When the unit is operating in Cool mode

1. Press the **good' sleep** button on the remote control to select Sleep Mode. The good' sleep indicator appears and the Off Timer indicator starts blinking on the remote control display.
2. Press the **good' sleep** button repeatedly to set the off time.
 - You can set the time in half-hour units from 30 minutes to 3 hours and hourly units from 3 hours to 12 hours.
 - The operation hours can be set from a minimum of 30 minutes to a maximum of 12 hours.
 - The default number of operation hours is set to 8 hours.
3. Press the **Set/Cancel** button to activate Sleep Mode. The Off Timer indicator stops blinking and the set time is displayed.

Note: Press the Set/Cancel button to start Sleep Mode within 10 seconds or the operation will be canceled. Check the Off indicator on the remote control display to be sure your off time is in effect.

To cancel Sleep Mode, press the Set/Cancel button once again.

Figure 8. Button used to start Sleep Mode operation

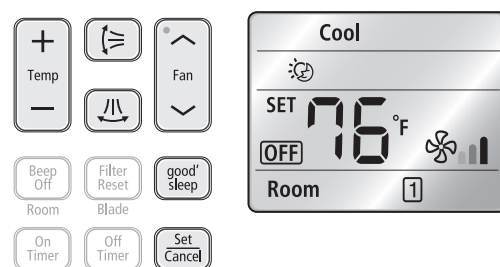

Temperature, fan speed, and air flow direction adjustments



You can set the desired temperature by 1°F within the range of 65°F–86°F.



The fan speed is adjusted automatically according to the Sleep mode.



The air flow direction is adjusted automatically according to the Sleep mode.



Sleep Modes

Fall asleep mode. Provides you with a comfortable sleep environment by rapidly cooling the room.

Sound sleep mode. The sound sleep mode adjusts temperature and air flow to maintain a healthy skin temperature and promote deep sleep. The sound sleep hours can be longer or shorter depending on any change to the Sleep Mode hours.

Wake up from Sleep mode. Provides air flow that adjusts your body temperature, so you wake up feeling refreshed.

Note:

- The recommended temperature setpoint is 77°F–81°F (25°C–27°C). The recommended ideal temperature is 79°F (26°C).
- If Sleep mode is set to < 4 hours, the operation will automatically stop after the set number of hours has passed. If Sleep mode is set > 5 hours,

the unit will run in Wake up mode during the last hour before operation automatically stops.

- If you press the Turbo, Mode, or Quiet button during Sleep mode, Sleep mode operation is canceled and the selected mode of operation starts.
- If both the On Timer/Off Timer and Sleep mode Off Timer functions have been set, only the timer set last is applied.

On/Off Timer

You can set the unit to turn on/off automatically at the desired time.

Setting the On Timer while the unit is off / Setting the Off Timer while the unit is on

1. Press **On Timer** or **Off Timer** button. (On) / (Off) timer indicator blinks on the remote controller display.
2. Press **On Timer** or **Off Timer** button repeatedly to set the time. You can set the time in half-hour units, from 30 minutes to 3 hours; and hour units, from 3 hours to 24 hours. The set hour is set to minimum 30 minutes and maximum 24 hours.
3. Press **Set/Cancel** button to activate it. (On) / (Off) indicators stop blinking and the set time is displayed.

Note: You must press the Set/Cancel button within 10 seconds after selecting the On Timer or Off Timer button or the unit will return to the previous status. Check the On or Off indicator on the remote control display to be sure your requested status is in effect.

To cancel operation, press the **Set/Cancel** button once again.

Figure 9. Setting the On Timer

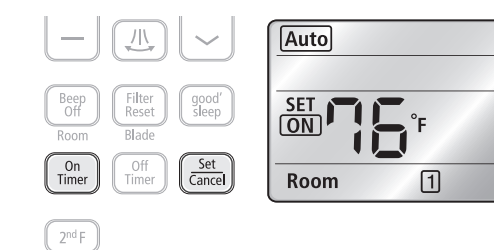
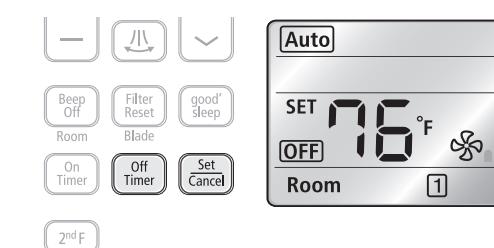

Figure 10. Setting the Off Timer



Additional options available in OnTimer mode

The following additional options are available in OnTimer mode:

Mode You can select from Auto > Cool > Dry > Fan > Heat.

Temp You can set the desired temperature by 1°F within the range of 65°F–86°F.

Notes:

- If both the On Timer/Off Timer and Sleep mode Off Timer functions have been set, only the timer set last is applied.
- About 10 seconds after setting the On Timer, the set time will be displayed on the remote controller.

Setting the On Timer and Off Timer simultaneously

If the unit is on and the preset time on the On Timer is shorter than the time set on the Off Timer **If the unit is off and the preset time on the On Timer is longer than the time set on the Off Timer**

For example, if the On Timer is set for 3 hours and the Off Timer is set for 5 hours: For example, if the On Timer is set for 3 hours, and the Off Timer is set for 1 hour:

- The unit will turn on after 3 hours from the moment you have set the timer.
- The unit will turn off after 1 hour from the moment you have set the timer.
- Your unit will remain on for 2 hours and then turn off automatically.
- After 2 hours, your unit will turn on.

Notes:

- The On Timer and Off Timer setting times must be different from each other.
- If you press the Set/Cancel button or Power button while the both On Timer and Off Timer are set simultaneously, the functions of both the On Timer and Off Timer are canceled at the same time.

Selecting Rooms

You can operate up to four indoor units separately.

1. With the unit powered on, press the 2ndF button and then press Beep Off/Room button.
2. Select indoor unit from 1 to 4, one at a time, or select all the indoor units by pressing the Room button repeatedly.

Figure 11. Buttons used to select rooms

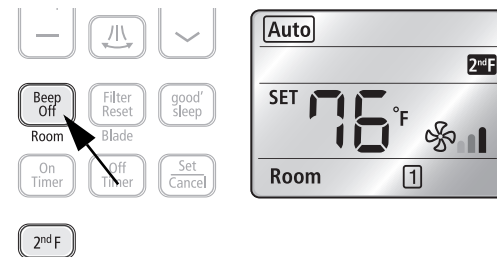

Selecting Blades

Note: Blade selection is available only with cassette indoor units.

 Vertical Air Swing button

 Horizontal Air Swing button

You can operate the four fan blades individually. While the unit is on, press the 2ndF button and select the blade you want to operate by pressing the **Filter Reset/Blade** button and then pressing the vertical **Air Swing** button. By pressing the Blade button repeatedly, you can select one or more individual blades or all blades.

Press the horizontal **Air Swing** button to cancel the selected blade.

Note: When selecting an individual blade, you cannot use the horizontal Air Swing button.

Figure 12. Buttons used to select blades

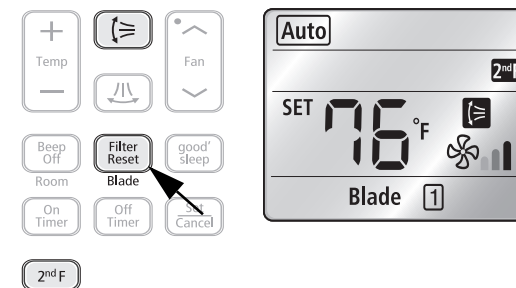

Changing Batteries

 When the battery is drained, the icon shown at left will appear in the remote control display. When this occurs, replace the two 1.5V AAA batteries.

Figure 13. Inserting the batteries



1. Push the lever as the arrow indicates on the rear side of the remote control and pull up.
2. Insert two AAA batteries. Check and match the "+" and "-" signs accordingly. Make sure you have inserted the batteries in the correct position.
3. Close the cover by placing it back to its original position. You should hear a click sound when the cover is locked properly.

Storage

When you do not use the remote control for an extended period of time, remove the batteries and store the device.

The manufacturer optimizes the performance of homes and buildings around the world. A business of Ingersoll Rand, the leader in creating and sustaining safe, comfortable and energy efficient environments, the manufacturer offers a broad portfolio of advanced controls and HVAC systems, comprehensive building services, and parts. For more information, visit www.IRco.com.

The manufacturer has a policy of continuous product and product data improvement and reserves the right to change design and specifications without notice.

© 2013 Trane All rights reserved
VRF-SVU40A-EN 15 Aug 2013
New

We are committed to using environmentally conscious print practices that reduce waste.

