



Product Data Sheet



Tracer™ XM32 Expansion Module

The Tracer XM32 Expansion Module provides additional points when needed for Tracer UC400 and UC600 applications. Each expansion module has a total of four (4) relay outputs. Use of a PM014 24Vac/24Vdc power supply (*Order Number X136515380*) is required for applications requiring more than two expansion modules.

Packaged Contents

- One (1) XM32 expansion module
- One (1) bag of 3-pin and 4-pin terminal connectors
- One (1) IMC cable harness

Important: *Visually inspect contents for obvious defects or damage. All components have been thoroughly inspected before leaving the factory. Any claims for damage incurred during shipment should be filed immediately with the carrier.*

XM32 Configurable Connections

The table below provides information about the XM32 configurable connections.

Table 1. Device connections

Connection	Quantity	Types	Range	Notes
Binary output (BO1 to BO4)	4	General purpose	10 A; up to 277 Vac	POWER NEEDS TO BE WIRED TO THE BINARY OUTPUT. ALL OUTPUTS ARE ISOLATED FROM EACH OTHER AND FROM GROUND OR POWER. RANGES GIVEN ARE PER CONTACT.
		Motor	1/3 hp @ 125 Vac or 1/2 hp @ 277	
		Pilot duty (inductive load)	2 A; up to 125 Vac	
		Resistive load	8 A; up to 250 Vac or 10 A; up to 30 Vac or 10 A; up to 30 Vdc	

Specifications and Dimensions

Storage	
Temperature:	-67°F to 203°F (-55°C to 95°C)
Relative humidity:	5% to 95% (noncondensing)
Operating	
Temperature:	-40°F to 158°F (-40°C to 70°C)
Humidity:	5% to 95% (noncondensing)
Power:	24 Vdc ±10%, 100 mA
<ul style="list-style-type: none"> Mounting weight of controller: Mounting weight of controller with terminal connectors: 	<ul style="list-style-type: none"> Mounting surface must support .43 lb. (.195 kg) Mounting surface must support .47 lb. (.213 kg)
Environmental rating (enclosure):	NEMA 1
Installation:	UL 840: Category 3
Pollution:	UL 840: Degree 2
Agency Compliance	
<ul style="list-style-type: none"> UL916 PAZX- Open Energy Management Equipment UL94-5V Flammability CE Marked FCC Part 15, Subpart B, Class B Limit 	

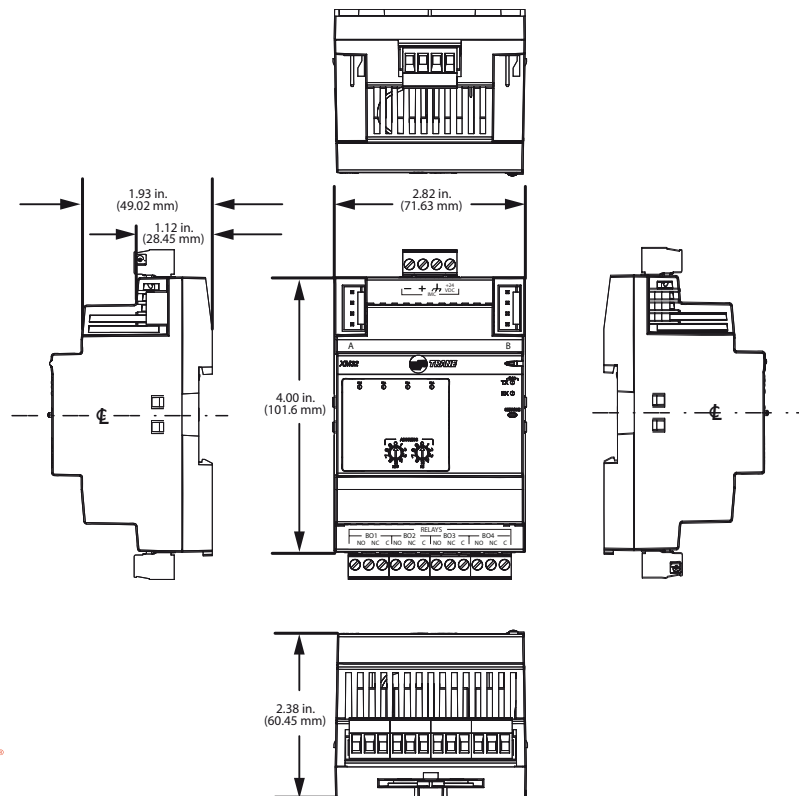

Trane optimizes the performance of homes and buildings around the world. A business of Ingersoll Rand, the leader in creating and sustaining safe, comfortable and energy efficient environments, Trane offers a broad portfolio of advanced controls and HVAC systems, comprehensive building services, and parts. For more information, visit www.Trane.com.

Trane has a policy of continuous product and product data improvement and reserves the right to change design and specifications without notice.

