

Installation Guide

Wind Baffle for Outdoor Units *VRF Single-Phase and C-Series Systems*

Model Numbers: CSERWINDBFL18AA
CSERWINDBFL24AA
CSERWINDBFL36AA

SAFETY WARNING

Only qualified personnel should install and service the equipment. The installation, starting up, and servicing of heating, ventilating, and air-conditioning equipment can be hazardous and requires specific knowledge and training. Improperly installed, adjusted or altered equipment by an unqualified person could result in death or serious injury. When working on the equipment, observe all precautions in the literature and on the tags, stickers, and labels that are attached to the equipment.

Warnings, Cautions, and Notices

Safety advisories appear throughout this manual as required. Your personal safety and the proper operation of this machine depend upon the strict observance of these precautions.

The three types of advisories are defined as follows:

WARNING

Indicates a potentially hazardous situation which, if not avoided, could result in death or serious injury.

CAUTION

Indicates a potentially hazardous situation which, if not avoided, could result in minor or moderate injury. It could also be used to alert against unsafe practices.

NOTICE

Indicates a situation that could result in equipment or property-damage only accidents.

Important Environmental Concerns

Scientific research has shown that certain man-made chemicals can affect the earth's naturally occurring stratospheric ozone layer when released to the atmosphere. In particular, several of the identified chemicals that may affect the ozone layer are refrigerants that contain Chlorine, Fluorine and Carbon (CFCs) and those containing Hydrogen, Chlorine, Fluorine and Carbon (HCFCs). Not all refrigerants containing these compounds have the same potential impact to the environment. Trane advocates the responsible handling of all refrigerants-including industry replacements for CFCs such as HCFCs and HFCs.

Important Responsible Refrigerant Practices

Trane believes that responsible refrigerant practices are important to the environment, our customers, and the air conditioning industry. All technicians who handle refrigerants must be certified. The Federal Clean Air Act (Section 608) sets forth the requirements for handling, reclaiming, recovering and recycling of certain refrigerants and the equipment that is used in these service procedures. In addition, some states or municipalities may have additional requirements that must also be adhered to for responsible management of refrigerants. Know the applicable laws and follow them.

WARNING

Proper Field Wiring and Grounding Required!

Failure to follow code could result in death or serious injury. All field wiring **MUST** be performed by qualified personnel. Improperly installed and grounded field wiring poses **FIRE** and **ELECTROCUTION** hazards. To avoid these hazards, you **MUST** follow requirements for field wiring installation and grounding as described in NEC and your local/state electrical codes.

WARNING

Personal Protective Equipment (PPE) Required!

Failure to wear proper PPE for the job being undertaken could result in death or serious injury. Technicians, in order to protect themselves from potential electrical, mechanical, and chemical hazards, **MUST** follow precautions in this manual and on the tags, stickers, and labels, as well as the instructions below:

- Before installing/servicing this unit, technicians **MUST** put on all PPE recommended for the work being undertaken. **ALWAYS** refer to appropriate MSDS sheets and OSHA guidelines for proper PPE.
- When working with or around hazardous chemicals, **ALWAYS** refer to the appropriate MSDS sheets and OSHA guidelines for information on allowable personal exposure levels, proper respiratory protection, and handling recommendations.
- If there is a risk of arc or flash, technicians **MUST** put on all PPE in accordance with NFPA 70E or other country-specific requirements for arc flash protection, **PRIOR** to servicing the unit.

Copyright

This document and the information in it are the property of Trane and may not be used or reproduced in whole or in part, without the written permission of Trane. Trane reserves the right to revise this publication at any time and to make changes to its content without obligation to notify any person of such revision or change.

Trademarks

All trademarks referenced in this document are the trademarks of their respective owners.

Product Description

Wind baffles are designed to provide protection from snow and wind gusts. Excessive snow and wind to unit outdoor coils can result in diminished performance.

If the outdoor unit will be operated in cooling mode when the ambient temperature is less than 23°F (-5°C) DB or if the outdoor unit might be exposed to direct strong winds, a wind baffle should be installed.

Model number	Components
CSERWINDBFL18AA	Front panel (1), Side panels (2), #10, 1/2 inch, self-tapping screws (10)
CSERWINDBFL24AA	Front panel (1), Top and lower panels (2), #10, 1/2 inch, self-tapping screws (12)
CSERWINDBFL36AA	Front panel (1), Side panels (2), #10, 1/2 inch, self-tapping screws (16)

Installation

The following notes and illustrations are provided to ensure proper installation of the wind baffle.

- *The wind baffle should be used only when the baffle is installed into the prevailing wind. The rear of the unit should be oriented towards an adequately sized wall or wind block. The wind baffle may not be effective if wind impinges on the sides or rear of the unit.*
- *Do not install a wind baffle if there are obstructions to the sides or above the unit.*
- *The outdoor unit must comply with minimum operating clearances as described in the IOM manual that shipped with your outdoor unit.*
- *If the application does not conform to the above recommendations, contact your local manufacturer sales office for further assistance.*

NOTICE

Coil damage!

Do not attempt to secure the wind baffle to the unit by drilling through the front cover of the wind baffle to screw it on. Coil damage could occur.

1. Remove all protective film from the baffle before assembling the wind baffle
2. Refer to the dimensional and assembly drawings to install the wind baffle. Pre-drilled holes match the locations of the pre-punched holes.

CSERWINDBFL18AA

Units: inch (cm)

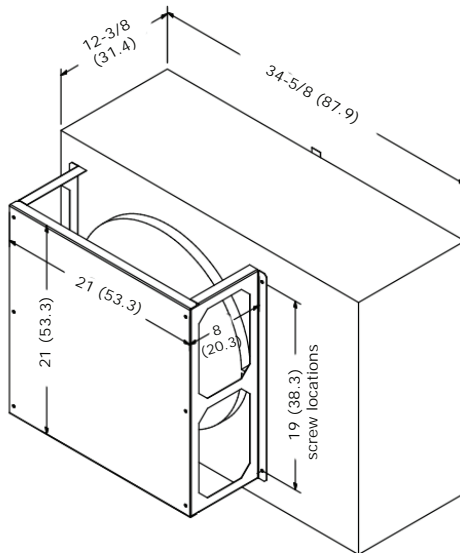
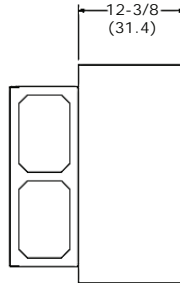
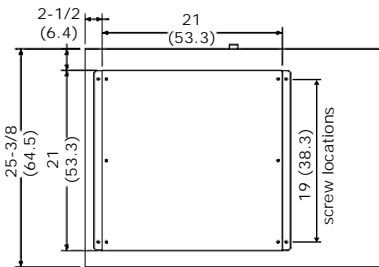
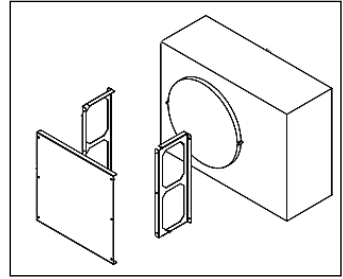
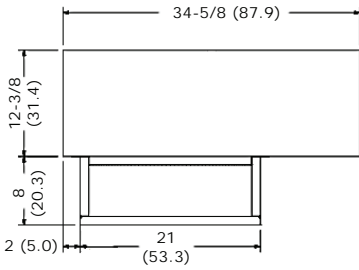

Installation

CSERWINDBFL24AA

Units: inch (cm)

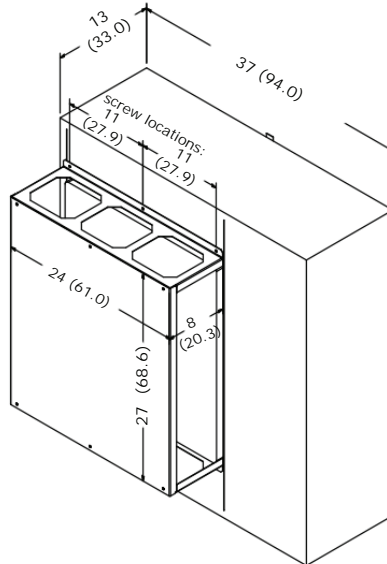
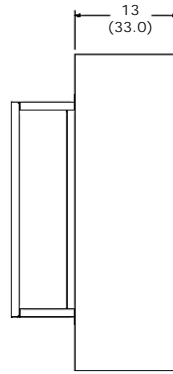
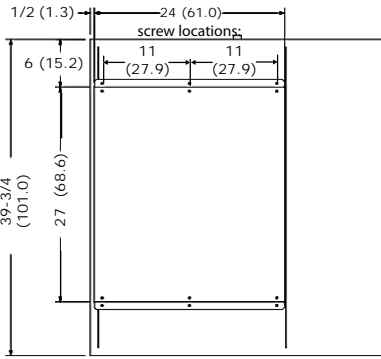
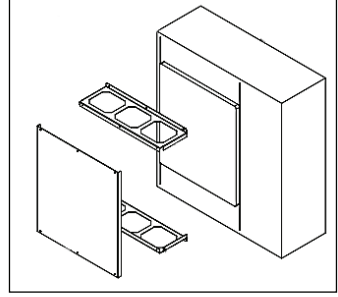
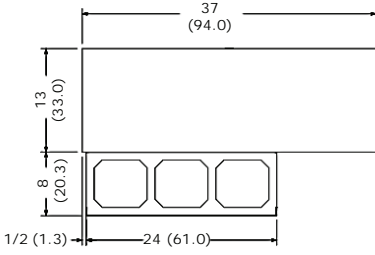

CSERWINDBFL36AA

Units: inch (cm)

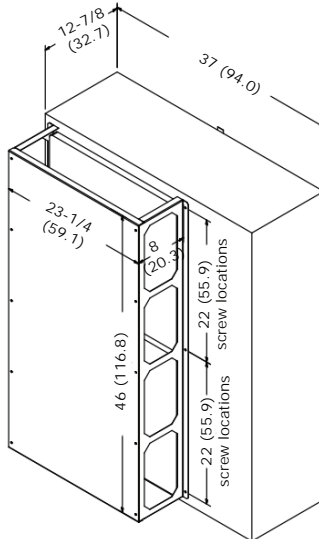
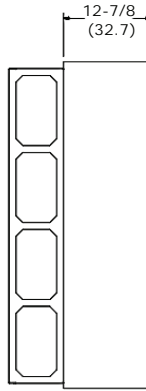
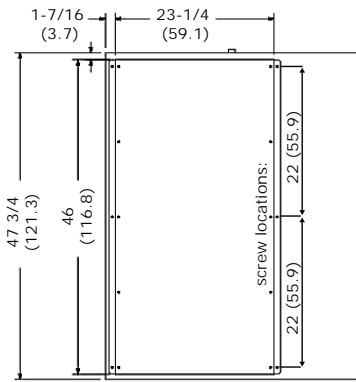
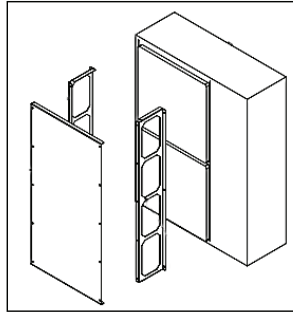
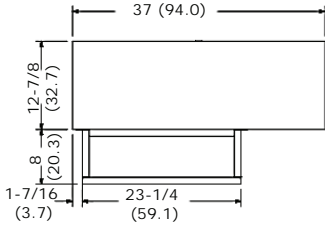

The manufacturer optimizes the performance of homes and buildings around the world. A business of Ingersoll Rand, the leader in creating and sustaining safe, comfortable and energy efficient environments, the manufacturer offers a broad portfolio of advanced controls and HVAC systems, comprehensive building services, and parts. For more information, visit www.IRCO.com.

The manufacturer has a policy of continuous product and product data improvement and reserves the right to change design and specifications without notice.

© 2015 Trane All rights reserved
VRF-SVN079A-EN 01 Oct 2015
(NEW)

We are committed to using environmentally
conscious print practices that reduce waste.

